



# RSA Multimodule series

Panels Power: 60W - 160W

Lumen: 5100LM - 18000LM



**RSA-40-P**



**RSA-60-M**



**RSA-100-M**



**RSA-160-M**



• Four different  
installation methods



Lamp post installation height recommendation diagram

Series	Recommended installation height
RSA-40-P	6-7m
RSA-60-M	6-8m
RSA-100-M	8-10m
RSA-160-M	9-12m

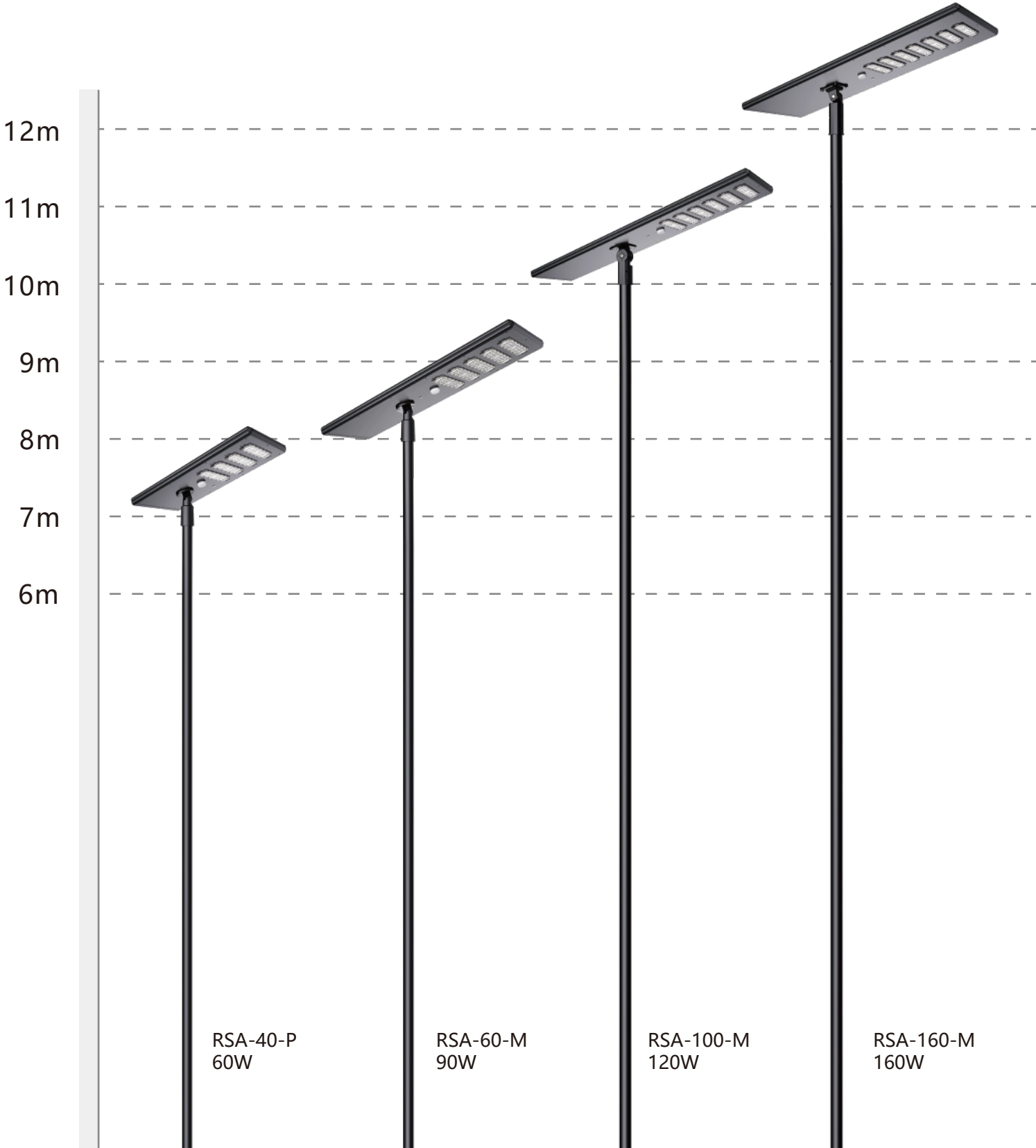

## Advantage

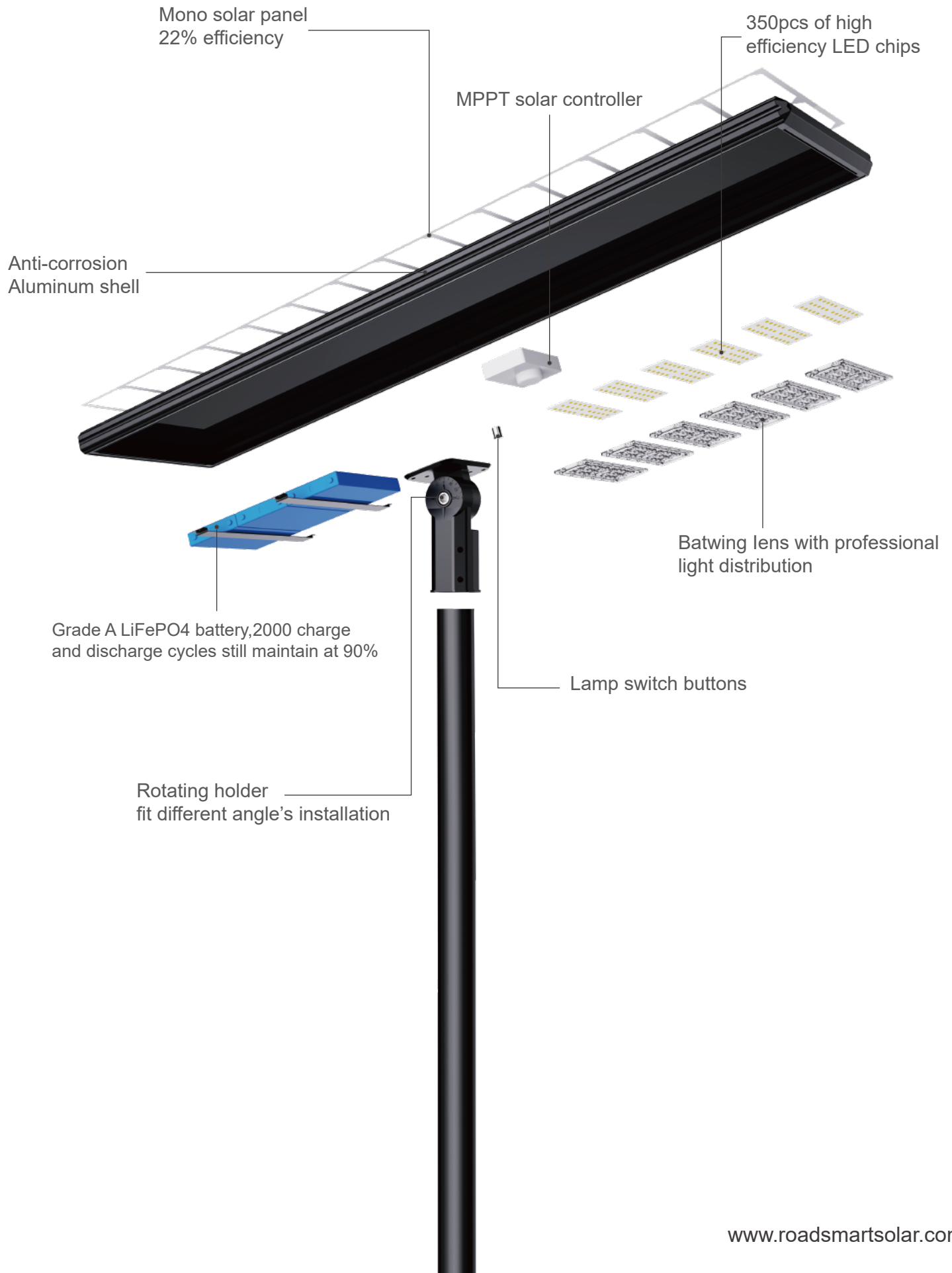

## Core Technologies



### **Patented appearance**

Integrated design of solar panel, microcomputer controller, lithium battery and high-efficiency LED light source



### **Modular design**

Modular design of battery and LED chip, transportation, installation and maintenance are more economical and simple



### **Proprietary control system**

RoadSmart self-developed solar controller can adjust different working modes freely, unique control system with more functions, stability is more stronger; Option of microwave induction function to save power and have longer lighting time



### **The fourth generation of intelligent power control**

Upgraded intelligent power control function to regulate reasonable discharge power according to intelligent judgment of recent weather conditions, support longer lighting time and more rainy days



### **Intelligent high-efficiency lamp chips**

350 pcs of high efficiency LED chips, optimized brightness, the whole lighting efficiency is greater than 160lm/w



### **Intelligent charge and discharge management**

Double protection of charging and discharging by software and hardware, and intelligent equalization technology, cycle charging and discharging more than 2000 times



### **Professional light distribution design**

Equipped with patented lens to make the irradiation area more uniform



### **Indicator lights of battery capacity**







Indicator lights of battery capacity display the power of the lamp obviously, which is convenient to observe the charging and discharging of the lamp



### **Rotating angle design**

The illumination area and angle of light can be adjusted reasonably according to the width of the road

## Remote Control

-  **DEMO:** No matter day or night, light "on" for 1 minute.  
Only for test use.
-  **OFF:** Light "off", no matter day or night.
-  **L:** At night, 100%-2hrs, 70%-2hrs, 30%-dawn.
-  **T:** At night, 100%-1hr, 70%-2hrs, 40%-3hrs.
-  **M:** At night, 50%-1hr, 100%-3hrs, 30%-dawn.
-  **U:** 100%-2hr, 70%-3hrs, 50%-3hrs, 20%-2hrs.

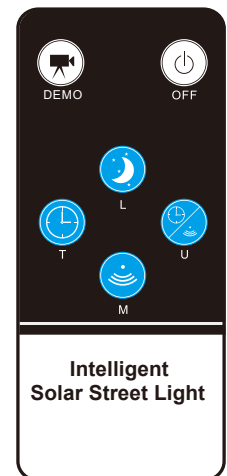

Note:

1. Default is L mode, once a certain mode was set successfully, it will be reserved until you change other modes with remote control.

## Light Distribution

Luminous intensity distribution curves.

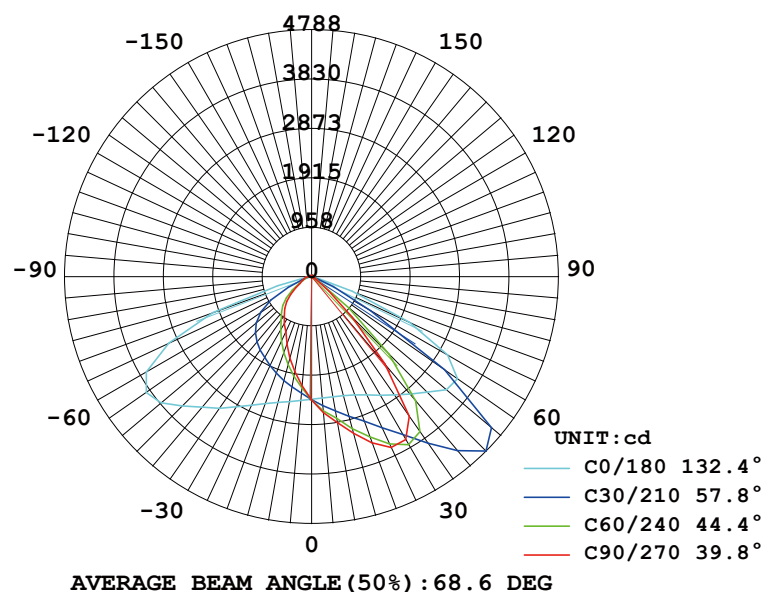
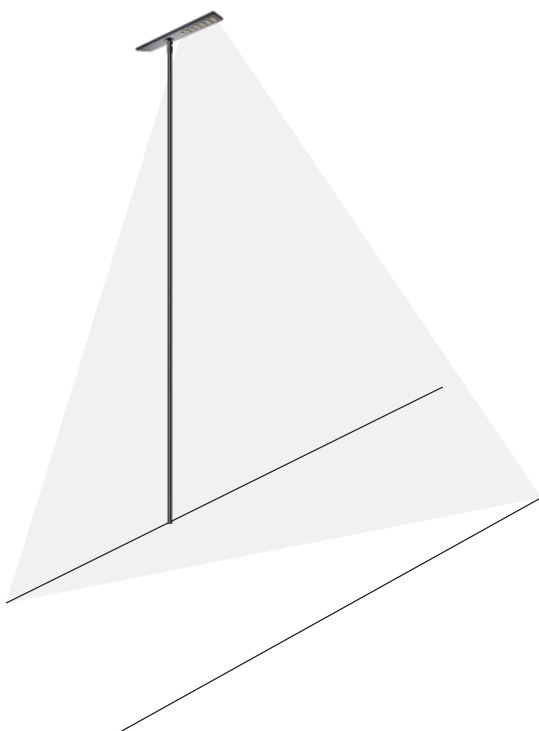

## Dimension

RSA-40-P

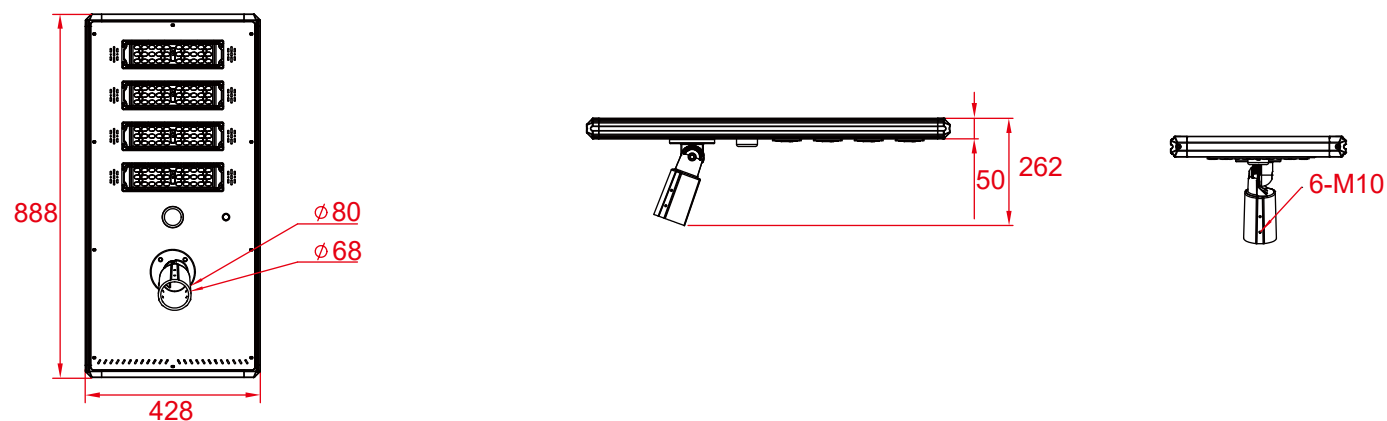

RSA-60-M

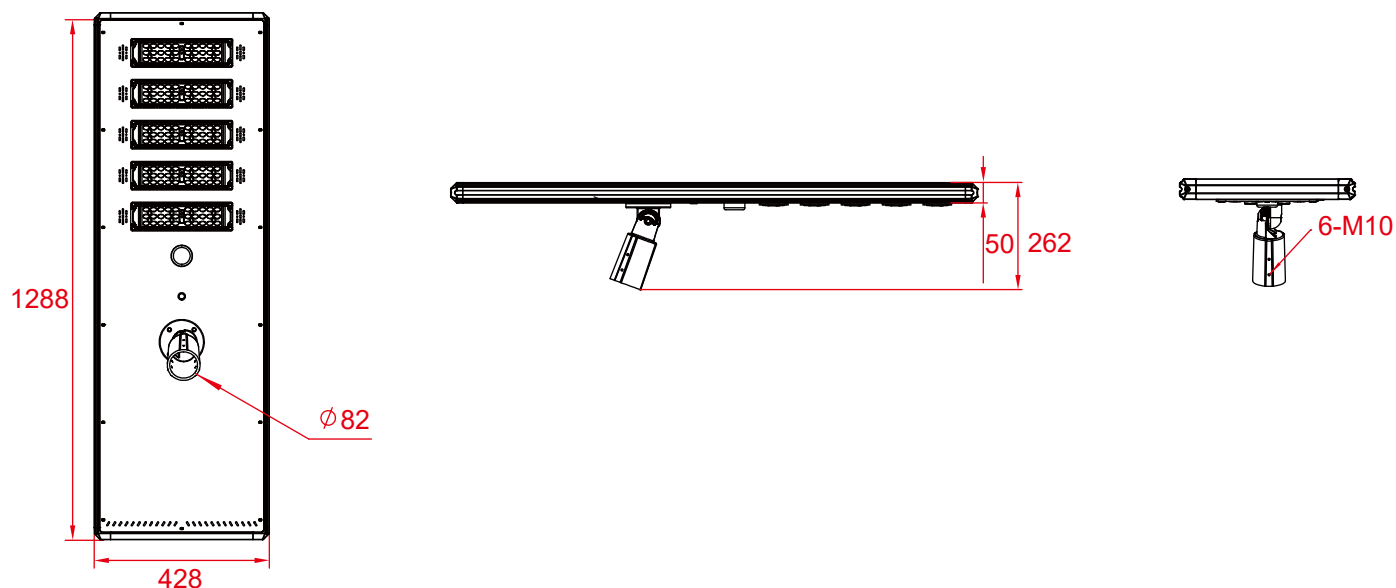

RSA-100-M

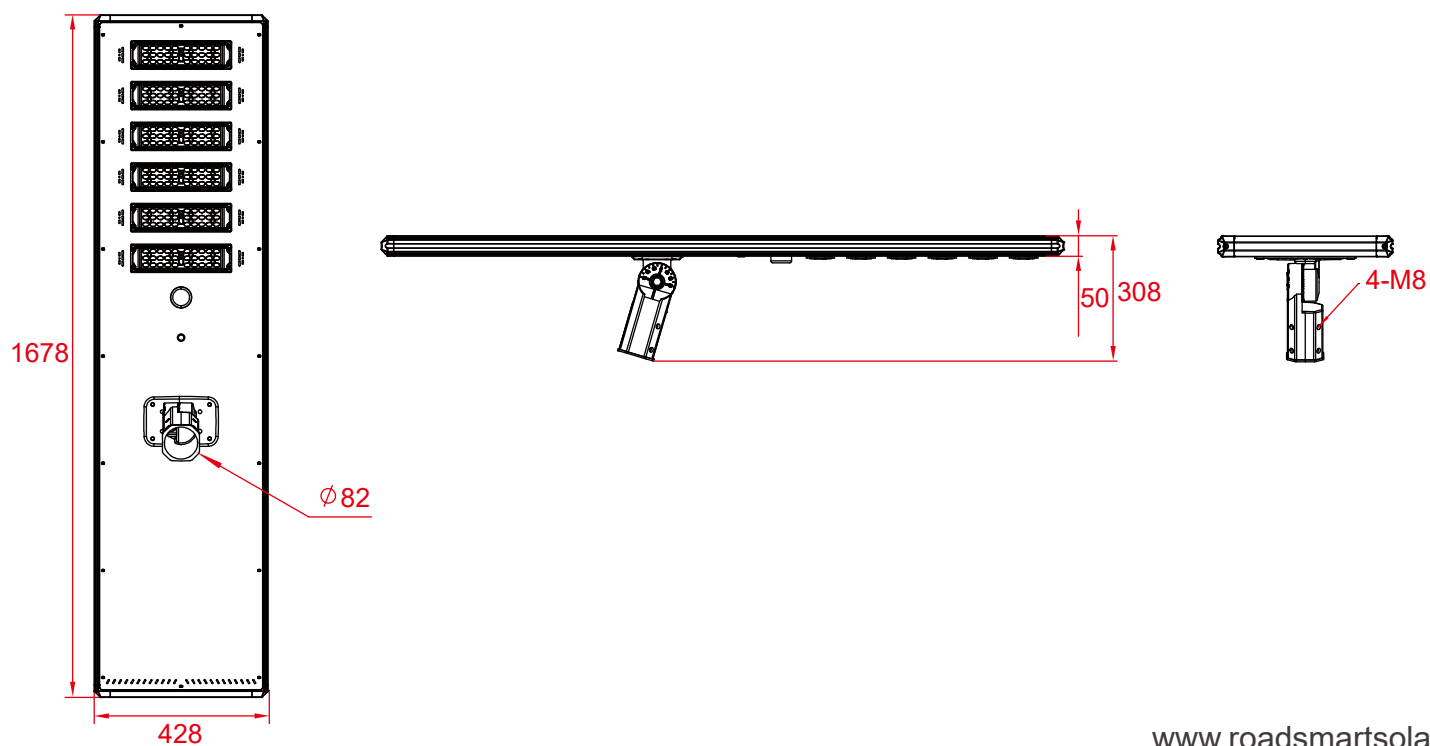



RSA-160-M

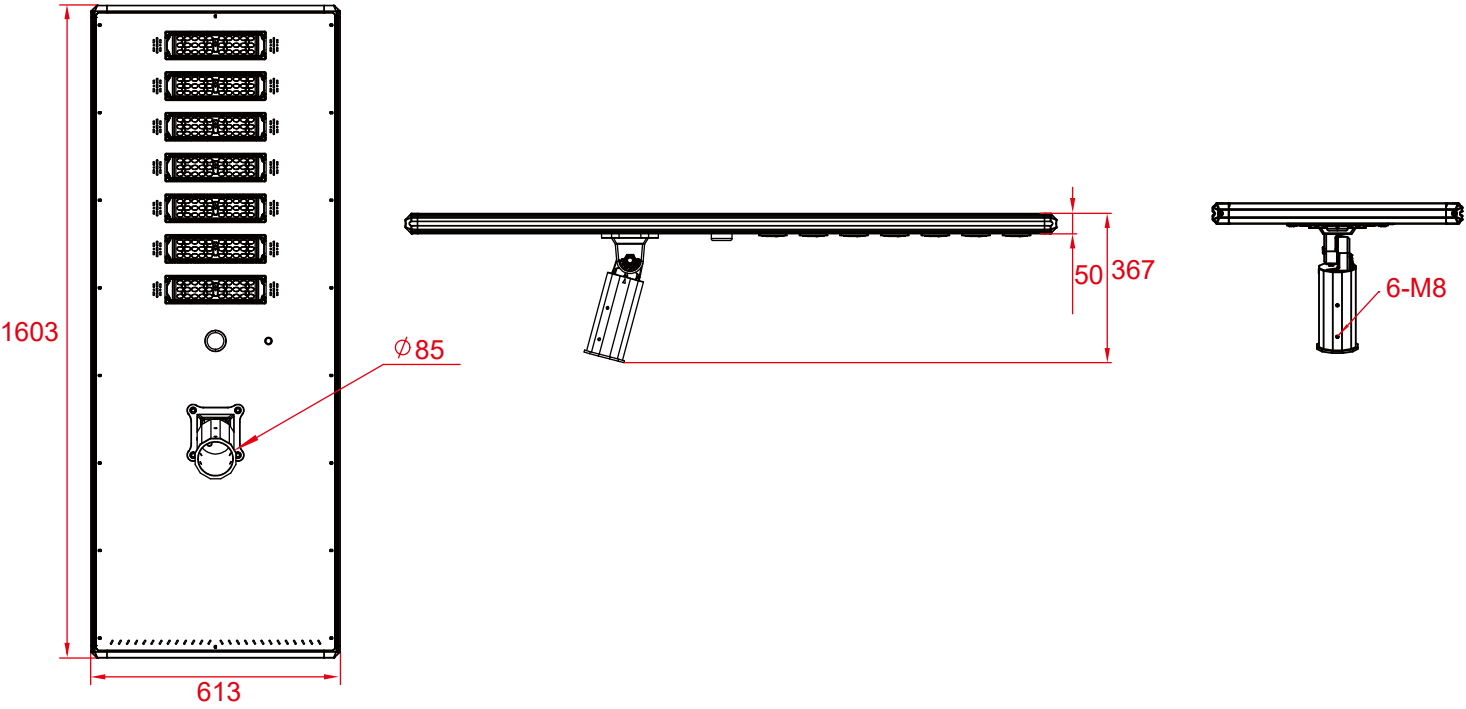

Sleeve depth

RSA-40-P / RSA-60-M

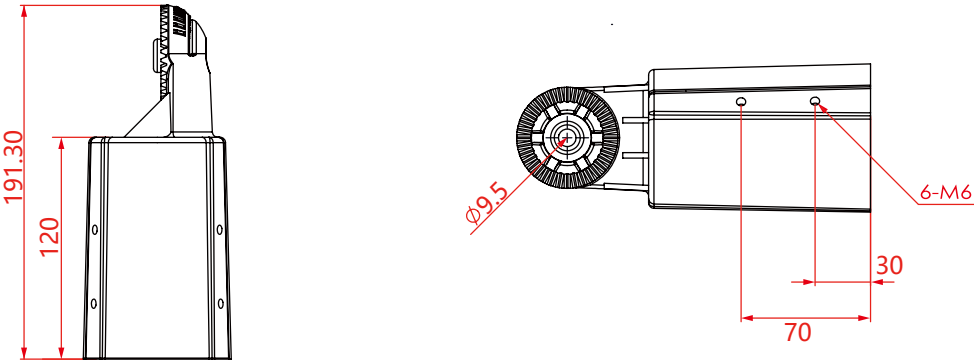

RSA-100-M

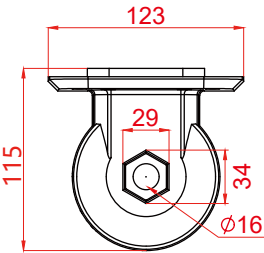
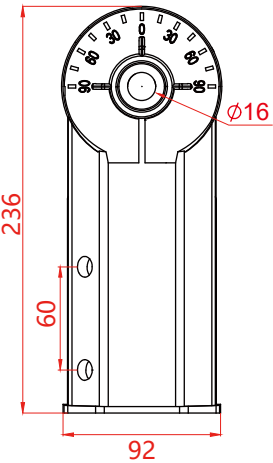

RSA-160-M

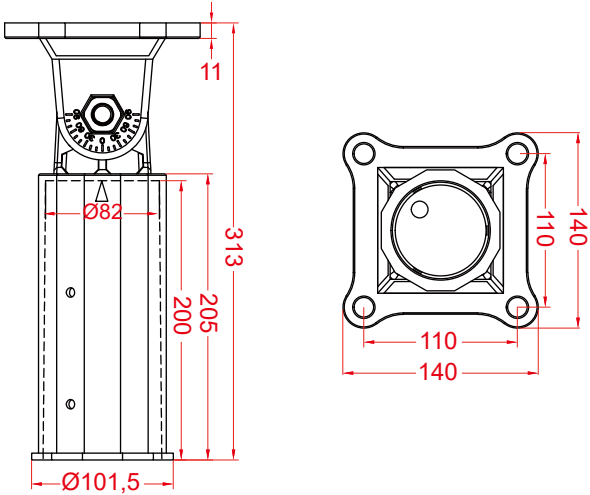

## Parameter

Type	RSA-40-P	RSA-60-M	RSA-100-M	RSA-160-M
Lamp head				
LED chip	200pcs	250pcs	300pcs	350pcs
Luminous flux	5100lm	9500pcs	13600lm	18000lm
Beam angle	150*70°			
Lifespan	50000hrs			
IP Rating	IP65			
Working temperature	-20°C~60°C (Charge above 0°C)			
Color temperature	3000-7500K			
CRI	Ra≥70			
SOLAR PANEL				
Power	60W	90W	120W	160W
Voltage	6V	18V		
Solar cell efficiency	19%-22%			
Material	Monocrystalline silicon			
BATTERY				
Capacity	75AH/240WH	135AH/432WH	200AH/640WH	260AH/832WH
Lighting time(full charged)	5-7 rainy days			
Lithium battery	LiFePO4			
INSTALLATION				
Top diameter of pole	60 mm		76 mm	
Mounting height	6-7M	6-8M	8-10M	9-12M
Installation spacing	20-40M			